

KVT GARDEN PHASE-II

The Greater Chennai Corporation
 APPROVED NO : 448 / 2016
 MADHAVARAM

PROPOSED LAYOUT OF HOUSE SITES IN
 SURVEY NO :525/1pt.,2, AND 525/3 OF
 MADHAVARAM VILLAGE , MADHAVARAM
 TALUK, THIRUVALLUR DISTRICT,GREATER
 CHENNAI CORPORATION, DIVISION NO.30,
 ZONE - III.

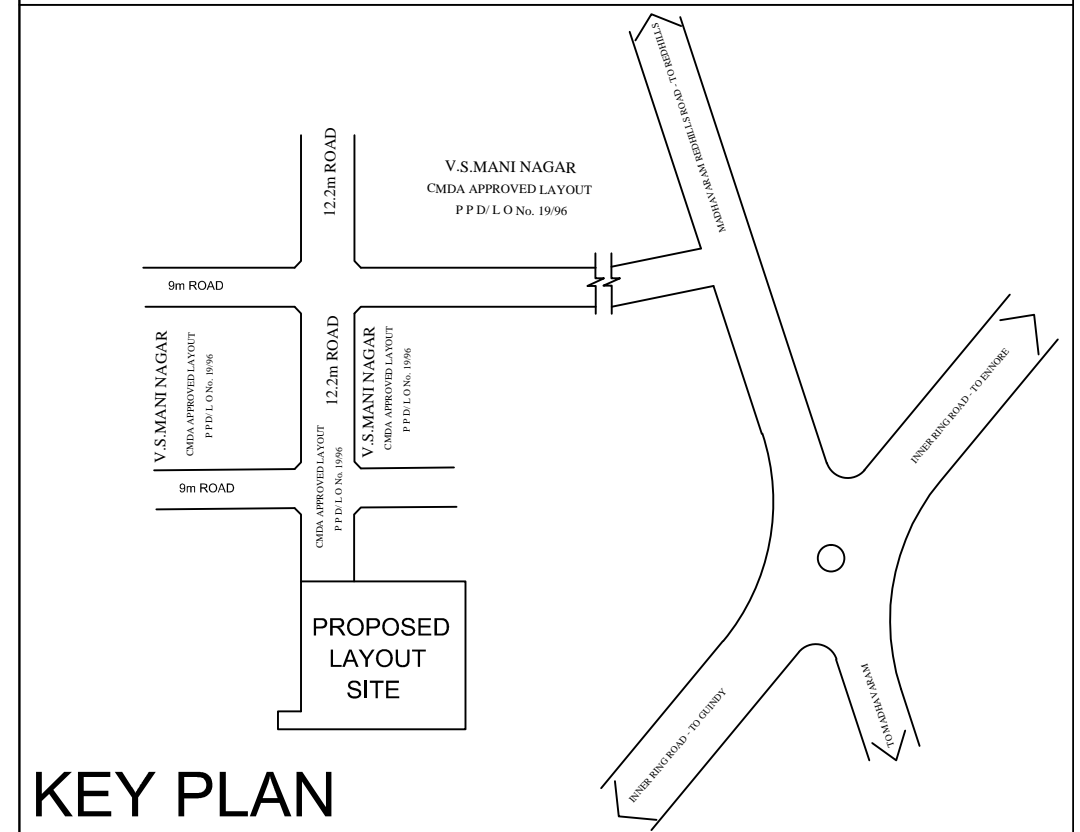
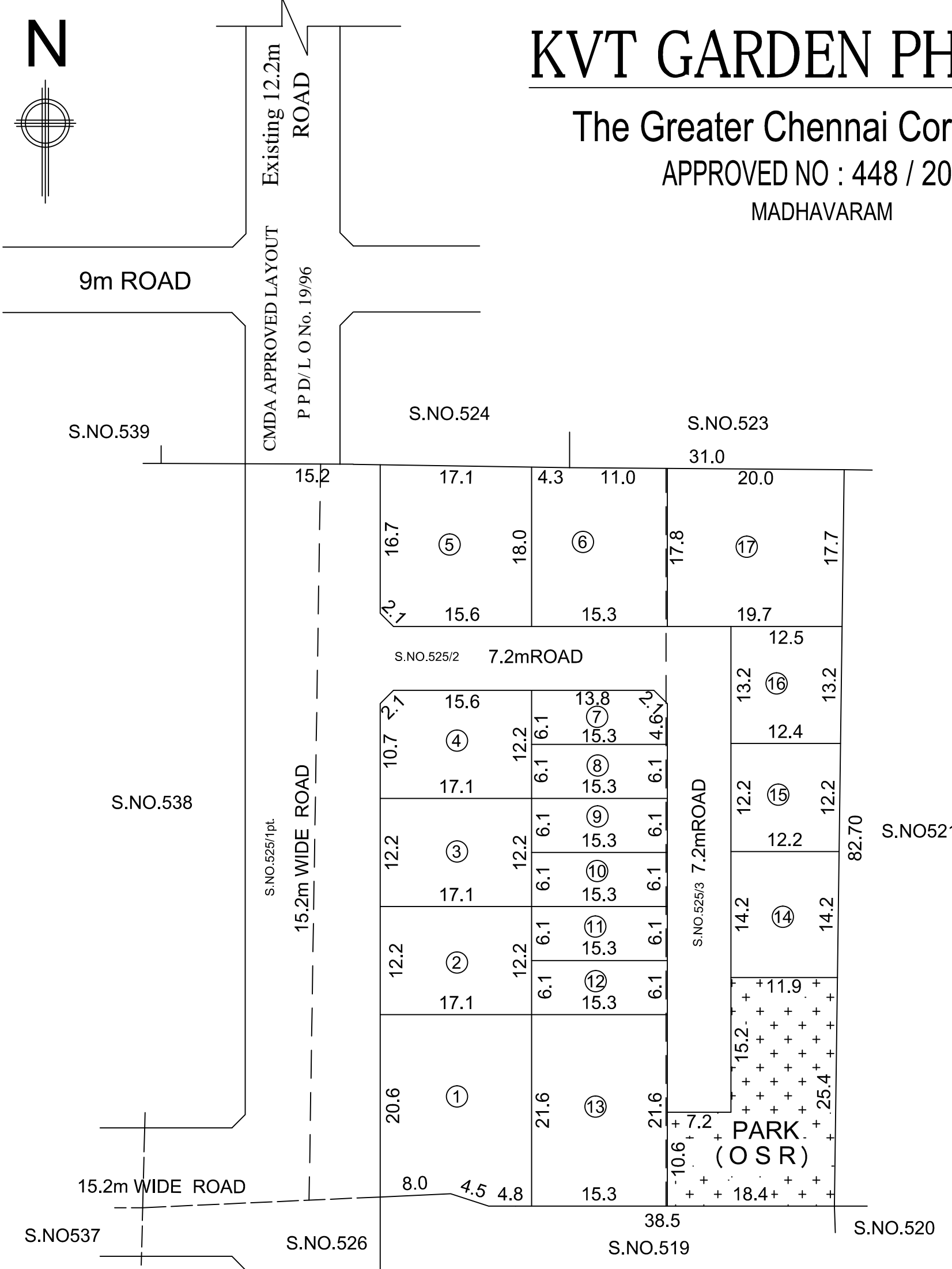

KEY PLAN

PLOT NO	EXTENT Sq. M	PLOT NO	EXTENT Sq. M
1	356.60	10	93.30
2	208.60	11	93.30
3	208.60	12	93.30
4	207.40	13	330.40
5	308.30	14	171.80
6	273.80	15	150.00
7	92.20	16	164.30
8	93.30	17	352.70
9	93.30		